

Index	2	Accessories	3
Safety information	2	Installation	4
Content	2	Programming	5
Technical	3	Magno dimming	6
Specifications	3	Zoom function	7
		List of symbols	8

SAFETY INFORMATION

Do not touch the LED surface.	Do not use the unit in a flammable or explosive area.	Do not stare into the LED.	Ambiance Max. 40°	Qualified technician	Disconnect the power supply before installing or maintaining
Make sure all connectors are connected properly	Use a source of AC power that complies to local electrical codes	Block access below the work area when maintaining the unit	Don't modify or install genuine parts on this product	Don't install in a flammable or explosive area	Warning! Some surfaces can be hot

CONTENT

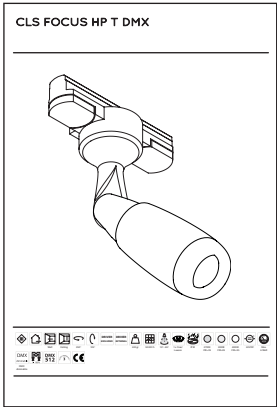
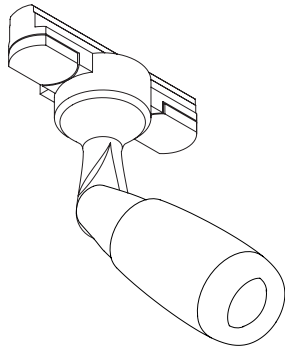

DMX dimmable	DMX 512	DMX 1-100%	CE													

TECHNICAL

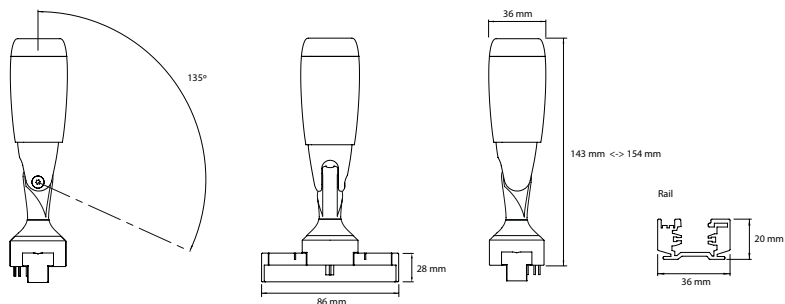

Tools

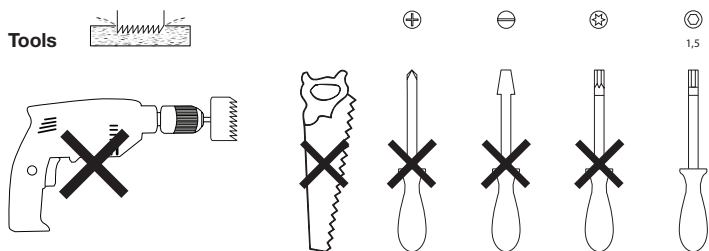

SPECIFICATIONS

LED:	1 x Luxeon / Cree
Available colours:	CRI=95: 2700K, 3000K & 4000K
Beam angle:	13° to 65°
Power supply:	24 VDC
Power consumption:	Max. 6 Watt
Housing:	Black aluminum brushed
Weight:	220 gr
IP value:	IP20
Measurements:	143 x 86 x 36 mm (hwxwd)
Ambient temperature:	-10° C till +40° C

ACCESSORIES

Y106012	CLS Focus snoot GII half cut black
Y106013	CLS Focus snoot GII half cut white
Y106014-B	CLS Focus snoot GII black
Y106017	CLS Magnet pin (5 pieces)
Y110802	CLS 1-fase rail + data 1 meter black
Y110812	CLS 1-fase rail + data 2 meter black
Y110822	CLS 1-fase rail + data 3 meter black
Y110822-**	CLS 1-fase rail + data, other colours on request
Y110838	CLS 1-fase rail + data mid-rail feed black
Y110839	CLS 1-fase rail + data mid feed i-coupler black
Y110840	CLS 1-fase rail + data end feed right black
Y110841	CLS 1-fase rail + data end feed left black
Y110842	CLS 1-fase rail + data end cap black
Y110843	CLS 1-fase rail + data l-coupler PE outside black
Y110844	CLS 1-fase rail + data l-coupler PE inside black
Y110845	CLS 1-fase rail + data T-coupler PE inside black
Y110846	CLS 1-fase rail + data T-coupler PE inside left black
Y110847	CLS 1-fase rail + data coupler black
Y110850	CLS 1-fase rail + data X-coupler black
Y110851	CLS 1-fase rail + data Flex-coupler black
Y110854-**	CLS 1-fase rail + data, other colors on request

INSTALLATION

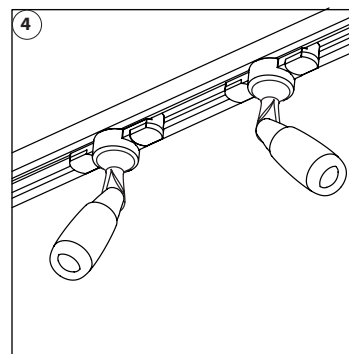
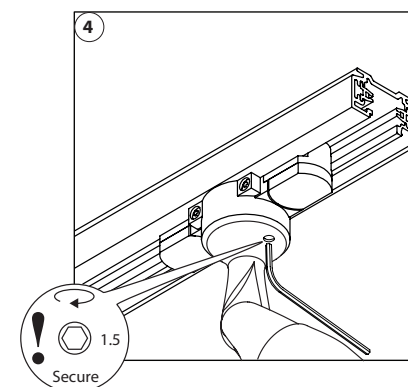
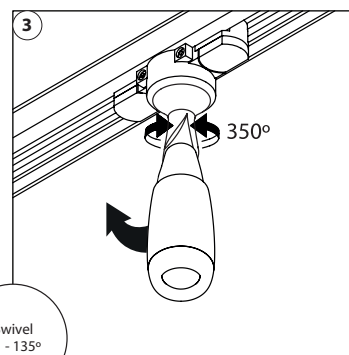
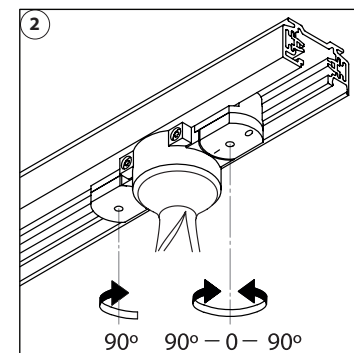
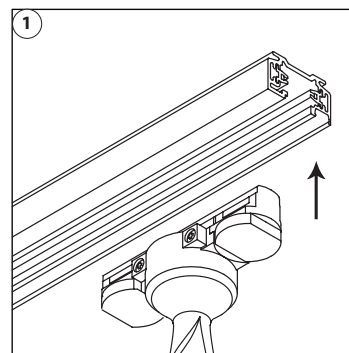

2020 CLS-LED BV. All rights reserved.
Information subject to change without notice,
CLS-LED BV and all affiliated companies disclaim
liability for injury, damage direct or indirect
loss, consequential or economic loss or any
other loss occasioned by the use of, inability to
use or reliance on the information contained
in this manual. No part of this manual may be
reproduced, in any form or by any means, without
permission in writing from CLS-LED BV. Other
legal information can be found in our General
conditions, found on the back of your CLS-LED
BV invoice, inside the CLS catalogue or on our
website www.cls-led.com/General-Terms.pdf

PROGRAMMING

MAGNO DIMMING

Works without DMX

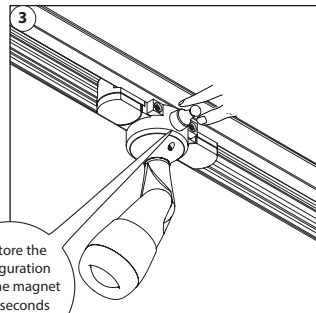
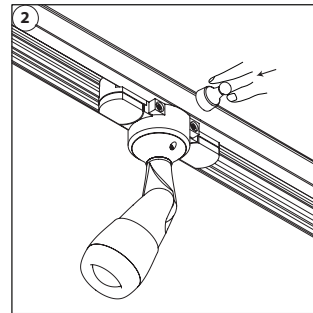
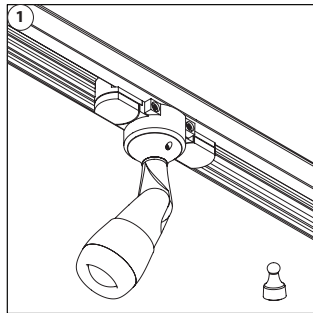

To store the configuration hold the magnet for 3 seconds on the Focus

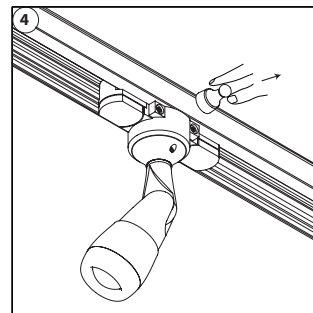

Via DMX the Focus Compact can be configured. After setting the DMX to the desired values just hold the magnet on the Focus adapter (between the 2 screws). Hold the magnet for approximately 3 seconds (step 3), when holding the magnet on the Focus it will turn on and when programming has finished the Focus will turn off again. When the light does not turn off after 3 seconds repower and try again.

Addressing

Configure address (1-255) set data on DMX channel 1:
0 = no changes are made.
1-255 = address is set to 1-255.

Configure address (256-508) set data on DMX channel 2:
0 = no changes are made.
1-253 = address is set to 256-508.

Examples:

Address 132 => set data 132 on DMX channel 1.
Address 278 => set data 23 on DMX channel 2.

Soft dim option

When active the Focus will have soft dim curve.
To configure the soft dim function, set data on DMX channel 4
0 = no changes are made.
<127 = function turned off.
>127 = function turned on.

Static brightness

When DMX fails / is not present, programmed brightness will become active.
To configure the static function, set DMX channel 3 to the desired brightness.
0 = no changes are made.
1 = function disabled.
2-255 = brightness of the fixture.

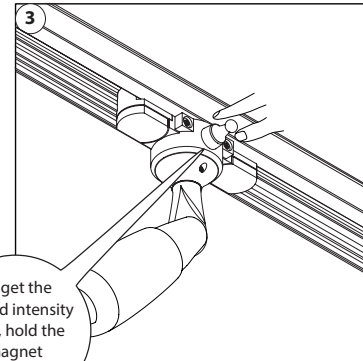
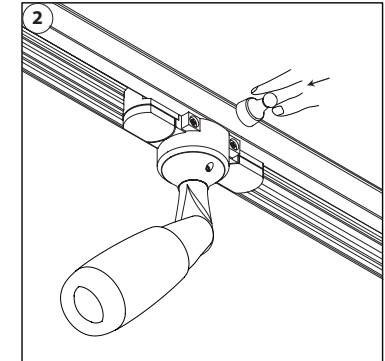
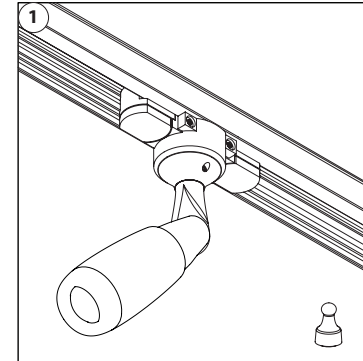

To get the desired intensity level, hold the magnet on the Focus

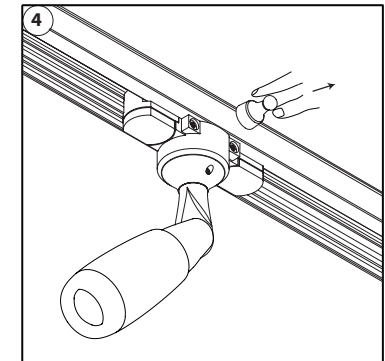

1. Place the magnet at the center between the 2 screws.
2. The Focus starts slowly dimming from 100 - 1% in approx. 30 seconds. The dimming is very accurate and precise, so steps are very small.
3. At the desired intensity level, take away the magnet.
4. After 10 seconds the Focus flashes one time, the value has been stored on the internal memory.
5. When powering up the Focus, the stored value will be recalled from the internal memory.
6. If you want to have a lower value, replace the magnet and the Focus dims further to lower levels. To store the new setting repeat step 3 - 5.
7. If the Focus is being dimmed to Level 0 and you have not programmed a value, it will automatically start at Level 100 and dim back from 100 - 1%.

ZOOM FUNCTION

LIST OF SYMBOLS

Twist system Applied on the black Focus

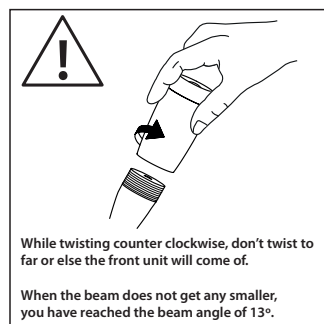
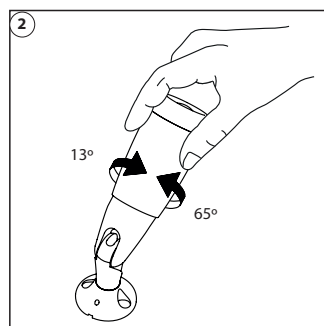
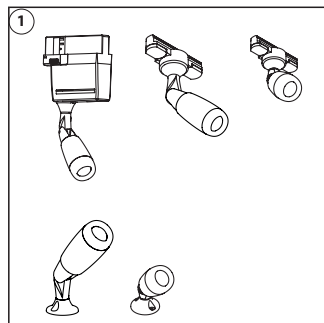

Pull & Push system Applied on the white Focus

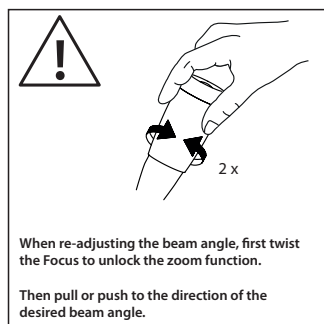
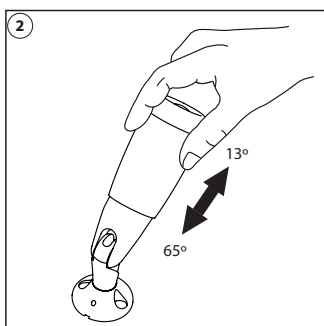
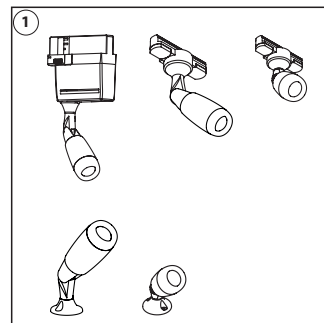

Protection class
One, two or three



Application area
Indoor or outdoor

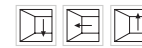

Application area
Floor, wall or ceiling



Swivel
Fixture is horizontally rotatable, indicated in degrees



Swivel
Fixture is vertically rotatable, indicated in degrees



Multiple connection
Daisychain connectivity



Installation depth
In centimeters



Installation size
In centimeters



Cable length
Maximum cable attached to the fixture in centimeters



Driver
Inclusive or exclusive internal or external



Weight
In grams/kilograms



Pressure
Maximum pressure on the fixture in kg/cm²



Lifespan
Of the light source in hours



Lenses
Available lenses, indicated in degrees



Performance Zoom
Adjustable beam angle



LEDs
Kind of LED used in the fixture



Plug & play
Easy connection using the SmartConnect system



IP value
Ingress Protection classifies the degrees of protection provided against the intrusion of the product



Colour changing
RGB, RGB-W, RGB-A, AWB or Tunable White



Retail & Food LED modules
Clothing, furniture, kitchens, jewellery, shoes, bread, meat, fish and vegetables & fruit.



Colour
Available colours:
Amber, blue, red or green



White colour temperature
In different Kelvin values:
Cold white, neutral white, warm white or extra warm white



Curve
Minimal bending curve in centimeters



Cutting length
Indicated by the cutting marks



LED pitch
Pitch between the LEDs in millimeters



Power supply
In VDC, VAC or milliAmpere



Power consumption
In VA or Watt



Dimmable
1-10 Volt, Phase, individual, DMX dimmable or DALI



PWM dimming
Traditional PWM dimming, DMX analog or DMX Hybrid dim



Bluetooth controlled
By Casambi



Magno dimming
Accurate dimming from 100 - 1% by using a magnet



Dynamic Control
Dynamic Power Control or Dynamic Temperature Control



DMX input
Fixture works on DMX512 protocol or Wireless DMX



Combined product
Compose your own fixture



Warranty
3 or 5 years warranty on the product



Conformité Européenne
CE marking for free marketability of industrial goods within the EU



Energy label



Lightsource
Equipped with a CLS, Citizen or a Xicato LED module