

Index	2	Installation	4
Safety information	2	Magno dimming	5
Content	2	Zoom function	6
Technical	3	Accessories	7
Specifications	3	List of symbols	8

SAFETY INFORMATION

Do not stare into the LED

Qualified technician

Disconnect the power supply before installing or maintaining

Make sure all connectors are connected properly

Use a source of AC power that complies to local electrical codes

Block access below the work area when maintaining the unit

Don't modify or install genuine parts on this product

Don't install in a flammable or explosive area

Warning! Some surfaces can be hot

CONTENT

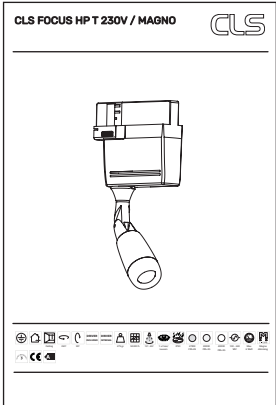
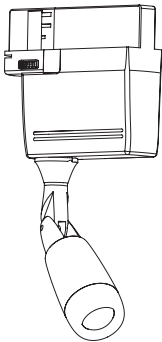

Ceiling

350°

90°

DRIVER INCLUDED

DRIVER INTERNAL

275 gr

50,000 h

13° - 65°

1 x Cree/Luxeon

IP20

2700K CRI=95

3000K CRI=95

4000K CRI=95

100 - 240 VAC

Max. 6 Watt

Magno dimming

3

CE

A

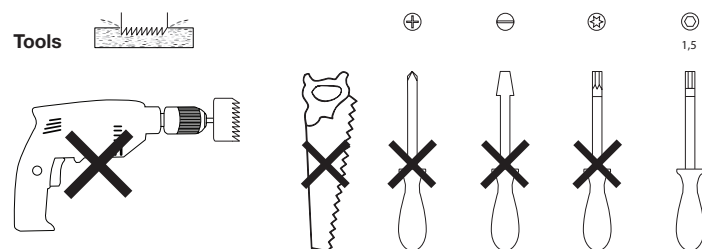
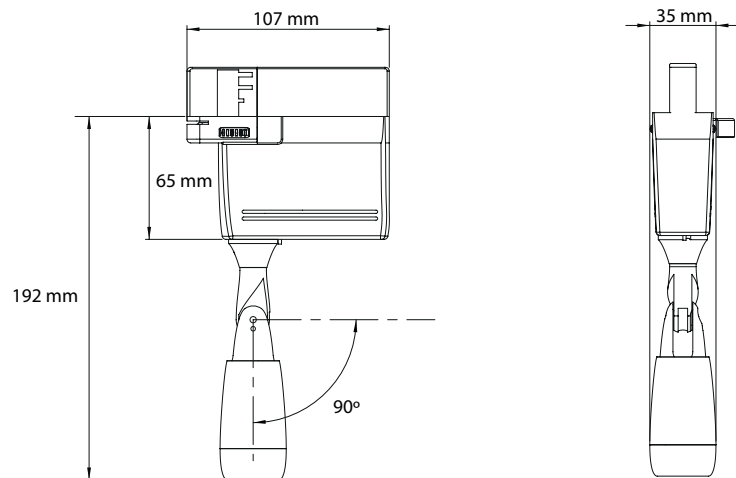

## SPECIFICATIONS

LED:	1 x High Power
Available colours:	CRI=95: 2700K, 3000K & 4000K
Beam angle:	13° to 65°
Power supply:	100 - 240 VAC
Power consumption:	Max. 6 Watt
Housing:	Black aluminum brushed
Weight:	275 gr
IP value:	IP20
Measurements:	192 x 107 x 35 mm (hwxwd)
Ambient temperature:	-10° C till +40° C

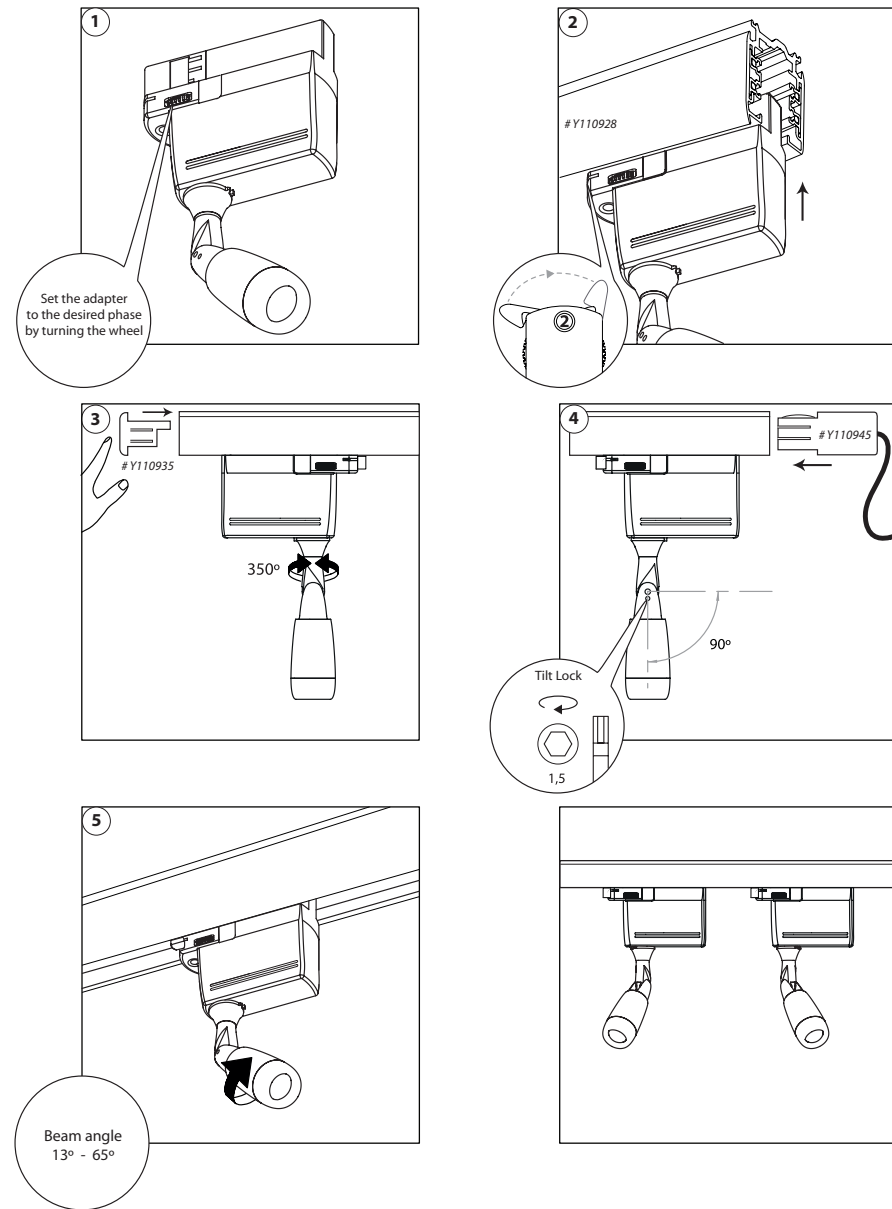

# MAGNO DIMMING

# ZOOM FUNCTION

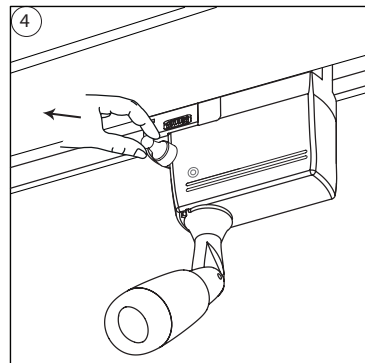
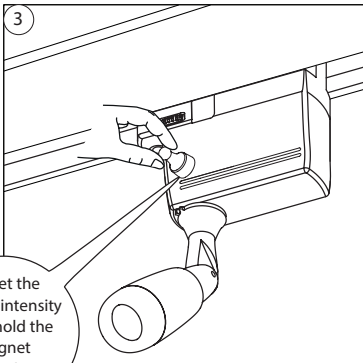
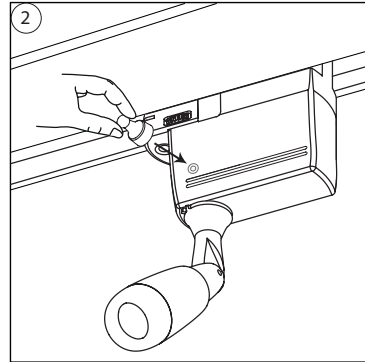
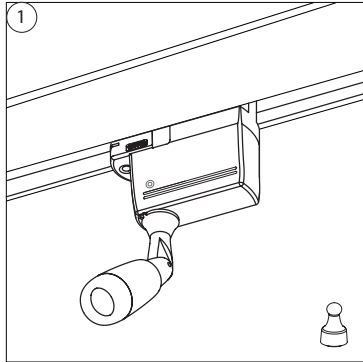

1. Place the magnet on the buseye, located on the side of the adapter.
2. The Focus T 230V starts slowly dimming from 100 – 1% in approx. 30 seconds. The dimming is very accurate and precise, so steps are very small.
3. At the desired intensity level, take away the magnet.
4. After 10 seconds the Focus T flashes one time, the value has been stored on the internal memory.
5. When powering up the Focus T, the stored value will be recalled from the internal memory.
6. If you want to have a lower value, replace the magnet and the Focus T 230V dims further to lower levels. To store the new setting repeat step 3 – 5.
7. If the Focus T 230V is being dimmed to Level 0 and you have not programmed a value, it will automatically start at Level 100 and dim back from 100 – 1 %.

## Twist system Applied on the black Focus

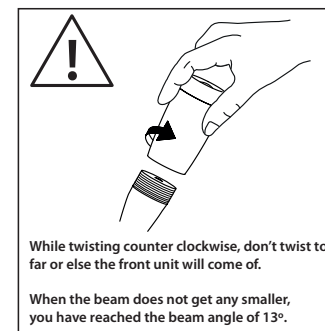
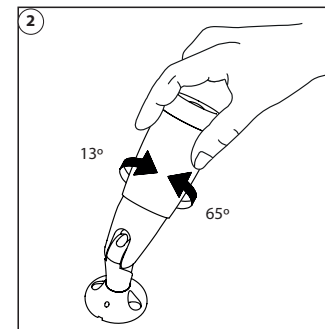
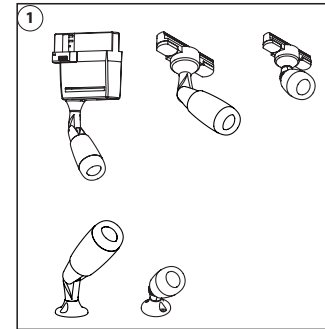

## Pull & Push system Applied on the white Focus

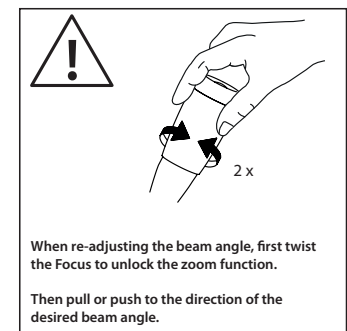
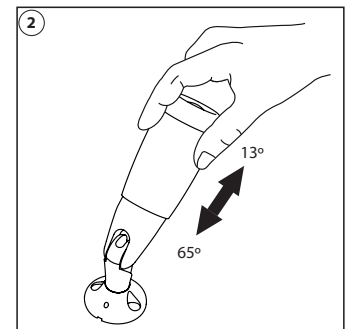
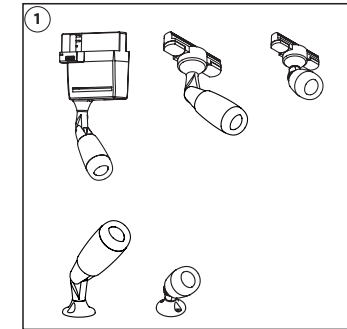

# ACCESSORIES

## ACCESSORIES

Y110855	CLS 3-phase multi adapter grey XTSA 68
Y110865	CLS 3-phase multi adapter white XTSA 68
Y110875	CLS 3-phase multi adapter black XTSA 68
Y110880	CLS T-connector grey for 3-phaserail, ground left
Y110881	CLS T-connector black for 3-phaserail, ground left
Y110882	CLS T-connector white for 3-phaserail, ground left
Y110925	CLS Global 3-phase rail 1 mtr grey XTS 4100
Y110926	CLS Global 3-phase rail 2 mtr grey XTS 4200
Y110927	CLS Global 3-phase rail 2mtr black XTS 4200
Y110928	CLS Global 3-phase rail 3mtr grey XTS 4300
Y110929	CLS Global 3-phase rail 4mtr grey XTS 4100
Y110930	CLS Global 3-phase rail 3mtr white XTS 4300
Y110931	CLS Global 3-phase rail 3mtr black XTS 4300
Y110932	CLS Global 3-phase rail 4mtr black XTS 4400
Y110935	CLS end piece for 3-phase rail grey XTS 41
Y110938	CLS end piece for 3-phase rail black XTS 41

Y106000	CLS Focus extension pipe 10 cm black
Y106001	CLS Focus extension pipe 10 cm white
Y106002	CLS Focus extension pipe 30 cm black
Y106003	CLS Focus extension pipe 30 cm white
Y106010	CLS Focus snoot GI half cut black
Y106013	CLS Focus snoot half cut white
Y106012	CLS Focus snoot GI half cut black
Y106014-B	CLS Focus snoot GII black
Y106014-W	CLS Focus snoot GII white

Y110939	CLS end piece for 3-phase rail white XTS 41-3
Y110945	CLS connection box for 3-phase rail, grey XTS 11
Y110946	CLS connection box for 3-phase rail, grey XTS 12
Y110950	CLS connection box for 3-phase rail black XTS 11
Y110954	CLS L-connector grey for 3-faseraill, ground left
Y110955	CLS L-connector grey for 3-faseraill, ground right
Y110960	CLS connect piece gray (connect rail-rail) XTS
Y110961	CLS connect piece white (connect rail-rail) XTS21
Y110962	CLS connect piece black (connect rail-rail) XTS
Y110965	CLS hanging bracke for 3-phase rail, grey SKB16
Y110966	CLS hanging set, grey SKB12 with 1.5 mtr steel
Y110970	CLS bending tool XTSV 12
Y110980	CLS Global monopoint GA70 grey
Y110985	CLS Global monopoint GA70 white
Y110990	CLS Global monopoint GA70 black
Y1106017	CLS Magnet pin (5 pcs)

2021 CLS-LED BV. All rights reserved. Information subject to change without notice, CLS-LED BV and all affiliated companies disclaim liability for injury, damage direct or indirect loss, consequential or economic loss or any other loss occasioned by the use of, inability to use or reliance on the information contained in this manual. No part of this manual may be reproduced, in any form or by any means, without permission in writing from CLS-LED BV. Other legal information can be found in our General conditions, found on the back of your CLS-LED BV invoice, inside the CLS catalogue or on our website [www.cls-led.com/General-Terms.pdf](http://www.cls-led.com/General-Terms.pdf)

# LIST OF SYMBOLS



**Protection class**  
One, two or three



**Application area**  
Indoor or outdoor



**Application area**  
Floor, wall or ceiling



**Swivel**  
Fixture is horizontally rotatable, indicated in degrees



**Swivel**  
Fixture is vertically rotatable, indicated in degrees



**Multiple connection**  
Daisychain connectivity



**Installation depth**  
In centimeters



**Installation size**  
In centimeters



**Cable length**  
Maximum cable attached to the fixture in centimeters



**Driver**  
Inclusive or exclusive  
Internal or external



**Weight**  
In grams/kilograms



**Pressure**  
Maximum pressure on the fixture in kg/cm²



**Lifespan**  
Of the light source in hours



**Lenses**  
Available lenses, indicated in degrees



**Performance Zoom**  
Adjustable beam angle



**LEDs**  
Kind of LED used in the fixture



**Plug & play**  
Easy connection using the SmartConnect system



**IP value**  
Ingress Protection classifies the degrees of protection provided against the intrusion of the product



**Colour changing**  
RGB, RGB-W, RGB-A, AWB or Tunable White



**Retail & Food LED modules**  
Clothing, furniture, kitchens, jewellery, shoes, bread, meat, fish and vegetables & fruit.



**Colour**  
Available colours:  
Amber, blue, red or green



**White colour temperature**  
In different Kelvin values:  
Cold white, neutral white, warm white or extra warm white



**Curve**  
Minimal bending curve in centimeters



**Cutting length**  
Indicated by the cutting marks



**LED pitch**  
Pitch between the LEDs in millimeters



**Power supply**  
In VDC, VAC or milliAmpere



**Power consumption**  
In VA or Watt



**Dimmable**  
1-10 Volt, Phase, individual, DMX dimmable or DALI



**PWM dimming**  
Traditional PWM dimming, DMX analog or DMX Hybrid dim



**Bluetooth control**  
By Casambi



**Magnet dimming**  
Accurate dimming from 100 - 1% by using a magnet



**Dynamic Control**  
Dynamic Power Control or Dynamic Temperature Control



**DMX input**  
Fixture works on DMX512 protocol or Wireless DMX



**Combined product**  
Compose your own fixture



**Warranty**  
3 or 5 years warranty on the product



**Conformité Européenne**  
CE marking for free marketability of industrial goods within the EU



**Energy label**



**Lightsource**  
Equipped with a CLS, Citizen or a Xicato LED module