

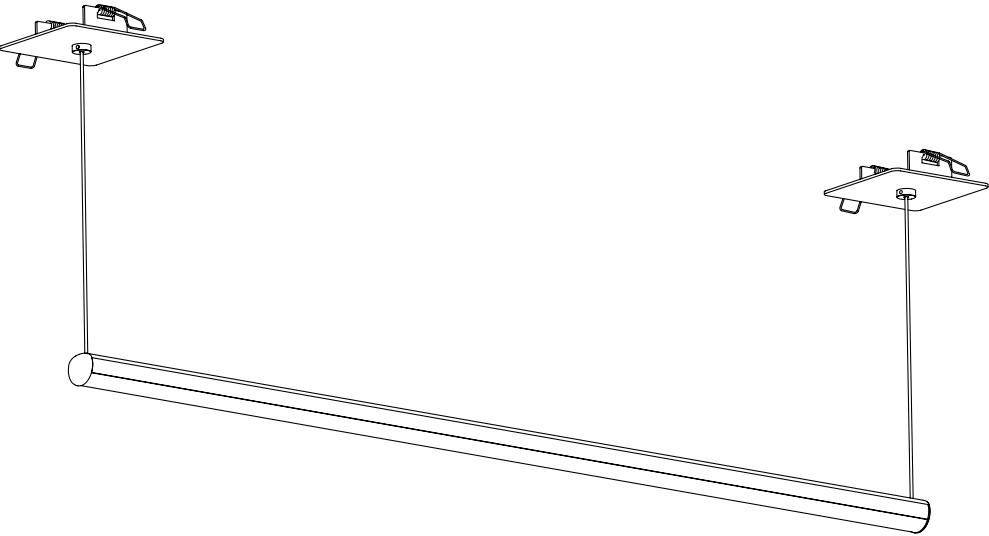

Index	2	Specifications	3
Safety information	2	Installation	4
Content	2	Connection DF	5
Technical	3	List of symbols	6



SAFETY INFORMATION

Always switch off mains power of the driver before connecting or maintaining any fixtures!

Make sure all connectors are connected properly

Use a source of AC power that complies to local electrical codes

Block access below the work area when maintaining the unit

Don't modify or install genuine parts on this product

Don't install in a flammable or explosive area

Warning! Some surfaces can be hot

Do not stare into the LED

Ambiance Max. 40°

Qualified technician

CONTENT

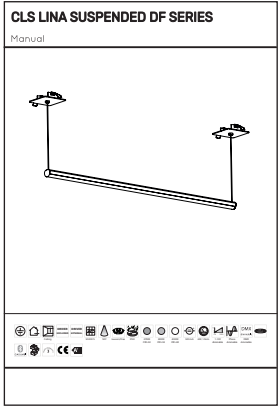
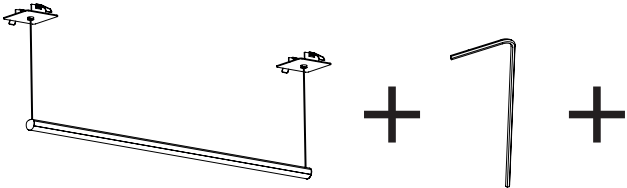

# TECHNICAL



A	Model
296 mm	Lina Suspended DF 30 cm
546 mm	Lina Suspended DF 55 cm
796 mm	Lina Suspended DF 80 cm

## Tools

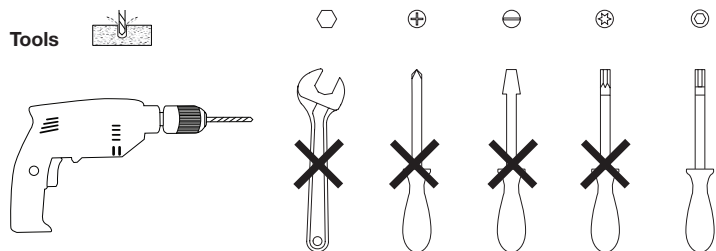

## SPECIFICATIONS

LED:	High Power LEDs
Available colours:	CRI>92: 2700K, 3000K CRI>80: 4000K
Power supply:	500mA
Power consumption:	Max. 6 Watt / 25 cm
Beam angle:	120°
Housing:	Black anodised aluminium, White coated
Cable length:	180 cm
Ambient temperature:	-20° C till +40° C

2021 CLS-LED BV. All rights reserved. Information subject to change without notice, CLS-LED BV and all affiliated companies disclaim liability for injury, damage direct or indirect loss, consequential or economic loss or any other loss occasioned by the use of, inability to use or reliance on the information contained in this manual. No part of this manual may be reproduced, in any form or by any means, without permission in writing from CLS-LED BV. Other legal information can be found in our General conditions, found on the back of your CLS-LED BV invoice, inside the CLS catalogue or on our website [www.cls-led.com/General-Terms.pdf](http://www.cls-led.com/General-Terms.pdf)

# INSTALLATION

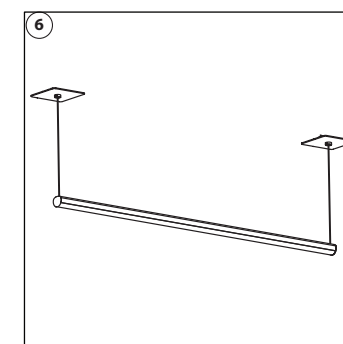
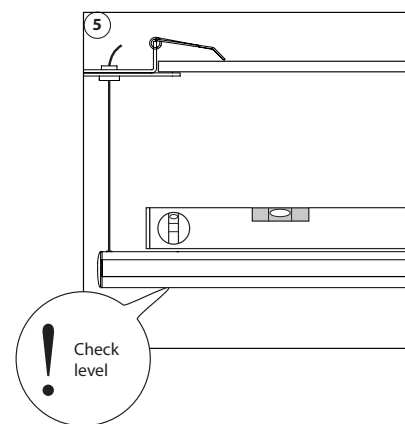
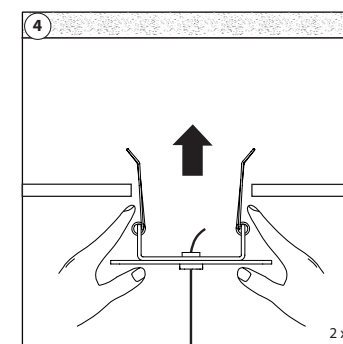
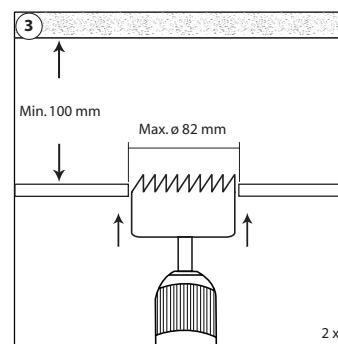
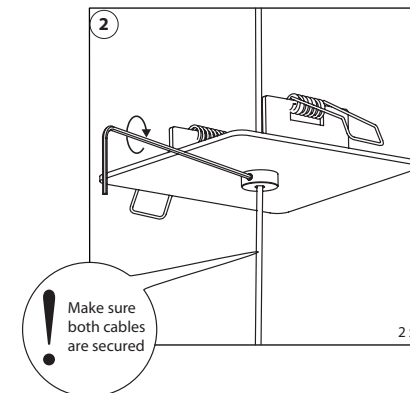
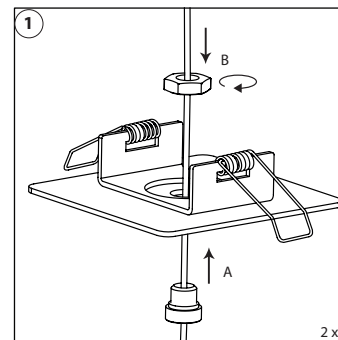



**Always switch off mains power of the driver before connecting any fixtures!**

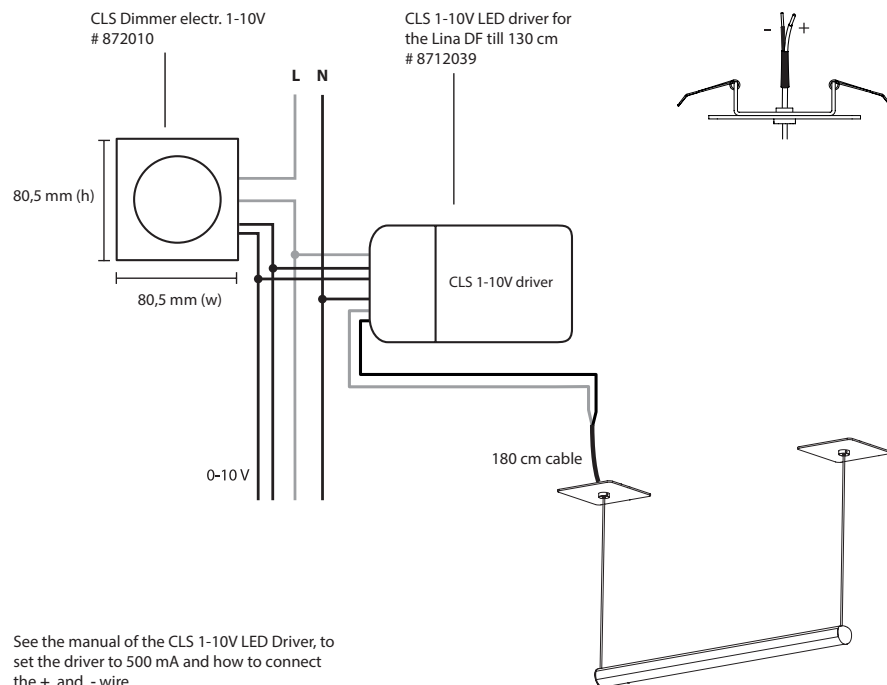

See the manual of the CLS 1-10V LED Driver, to set the driver to 500 mA and how to connect the + and - wire.

## Number of Lina Suspended DF on the CLS 1-10V LED driver

CLS Lina driver	
Fixture	#
Lina DF 30	1 - 7
Lina DF 55	1 - 3
Lina DF 80	1 - 2



- It is possible to combine different LINA DF length as long as the total number of LEDs is not higher than 25.
- Total cable length should not be longer than 10 meter.

	<b>Protection class</b> One, two or three		<b>Retail &amp; Food LED modules</b> Clothing, furniture, kitchens, jewellery, shoes, bread, meat, fish and vegetables & fruit.
	<b>Application area</b> Indoor or outdoor		<b>Colour</b> Available colours: Amber, blue, red or green
	<b>Application area</b> Floor, wall or ceiling		<b>White colour temperature</b> In different Kelvin values: Cold white, neutral white, warm white or extra warm white
	<b>Swivel</b> Fixture is horizontally rotatable, indicated in degrees		<b>Curve</b> Minimal bending curve in centimeters
	<b>Swivel</b> Fixture is vertically rotatable, indicated in degrees		<b>Cutting length</b> Indicated by the cutting marks
	<b>Multiple connection</b> Daisychain connectivity		<b>LED pitch</b> Pitch between the LEDs in millimeters
	<b>Installation depth</b> In centimeters		<b>Power supply</b> In VDC, VAC or milliAmpere
	<b>Installation size</b> In centimeters		<b>Power consumption</b> In VA or Watt
	<b>Cable length</b> Maximum cable attached to the fixture in centimeters		<b>Dimmable</b> 1-10 Volt, Phase, individual, DMX dimmable or DALI
	<b>Driver</b> Inclusive or exclusive Internal or external		<b>PWM dimming</b> Traditional PWM dimming, DMX analog or DMX Hybrid dim
	<b>Weight</b> In grams/kilograms		<b>Bluetooth controlled</b> By Casambi
	<b>Pressure</b> Maximum pressure on the fixture in kg/cm²		<b>Magne dimming</b> Accurate dimming from 100 - 1% by using a magnet
	<b>Lifespan</b> Of the light source in hours		<b>Dynamic Control</b> Dynamic Power Control or Dynamic Temperature Control
	<b>Lenses</b> Available lenses, indicated in degrees		<b>DMX input</b> Fixture works on DMX512 protocol or Wireless DMX
	<b>Performance Zoom</b> Adjustable beam angle		<b>Combined product</b> Compose your own fixture
	<b>LEDs</b> Kind of LED used in the fixture		<b>Warranty</b> 3 or 5 years warranty on the product
	<b>Plug &amp; play</b> Easy connection using the SmartConnect system		<b>Conformité Européenne</b> CE marking for free marketability of industrial goods within the EU
	<b>IP value</b> Ingress Protection classifies the degrees of protection provided against the intrusion of the product		<b>Energy label</b>
	<b>Colour changing</b> RGB, RGB-W, RGB-A, AWB or Tunable White		<b>Lightsource</b> Equipped with a CLS, Citizen or a Xicato LED module