

Index	2	Installation	4
Safety information	2	Lens replacement	5
Content	2	Lens index	6
Technical	3	Magno dimming	7
Specifications	3	List of symbols	8

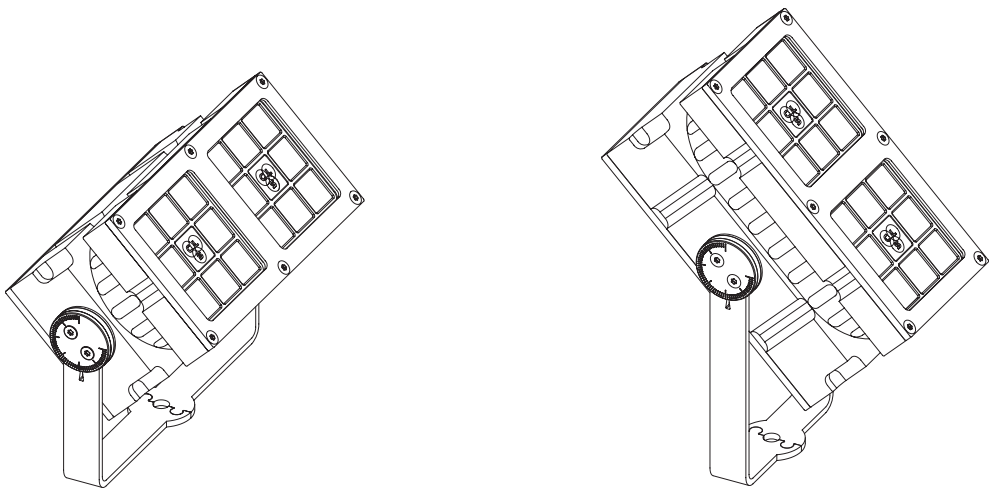

SAFETY INFORMATION

Make sure all connectors are connected properly

Use a source of AC power that complies to local electrical codes

Block access below the work area when maintaining the unit

Don't modify or install genuine parts on this product

Don't install in a flammable or explosive area

Warning! Some surfaces can be hot

Ambiance Max. 40°

Qualified technician

Disconnect the power supply before installing or maintaining

CONTENT

12 x 46°	16 x	IP67	2700K	3000K	4000K	5000K	6500K	Amber	Blue	Red	Green	100-240 VAC	Max. 40 Watt	1-10V dimmable	Mains dimmable	1-100% Magno dimming	12 x 46°

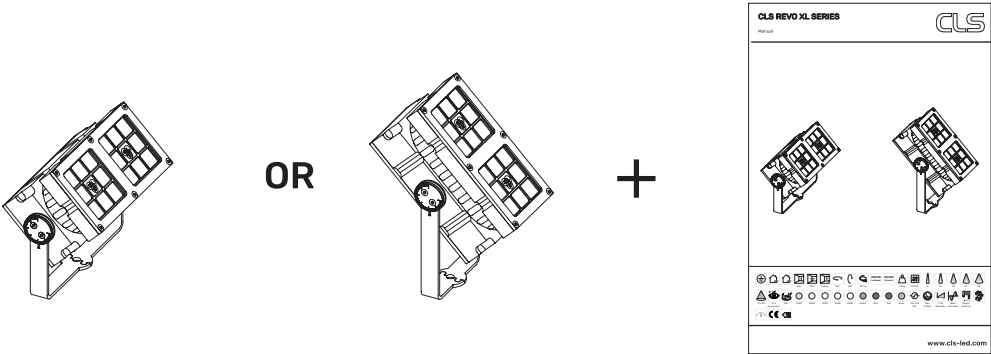

REVO Basic XL (Bracket on long side)

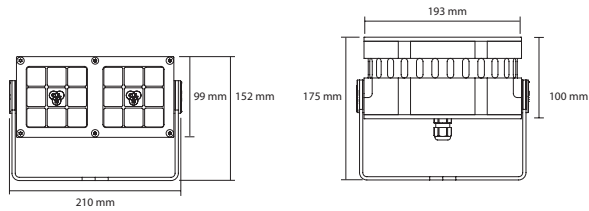

REVO Basic XL (Bracket on short side)

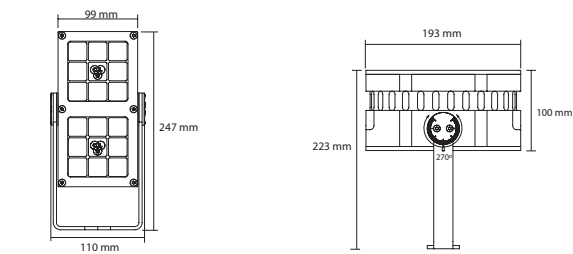

Tools

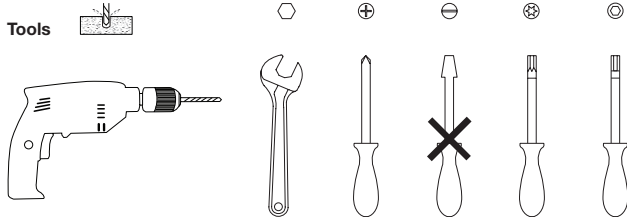

SPECIFICATIONS

LED:	16 x High Power LED
Available colours:	2700K, 3000K, 4000K, 5000K, 6500K, amber, red, green and Royal blue
Lenses:	8°, 12°, 30°, 61°, 80 and 12x46°
Power supply:	100 ~ 240 VAC
Power factor:	> 0,99 (115VAC), > 0,95 (230 VAC)
Power consumption:	Max. 40 Watt
Housing:	Anodised aluminum
Weight:	3,6 kg
IP value:	IP67
Cable length:	2 meters
Ambient temperature:	-30° C till +50° C

ACCESSORIES

110415	CLS Revo lens kit superspot 8°, 8 lenses
110425	CLS Revo lens kit spot 12°, 8 lenses
110435	CLS Revo lens kit medium flood 30°, 8 lenses
110445	CLS Revo lens kit wide flood 61°, 8 lenses
110455	CLS Revo lens kit elliptical 12x46°, 8 lenses
871992	CLS mold set, straight 8-26mm
871995	CLS mold set Paguro grey
Y106016	CLS Magnet pin (4 pcs)
Y110795-G	CLS REVO XL snoot grey
Y110795-B	CLS REVO XL snoot black

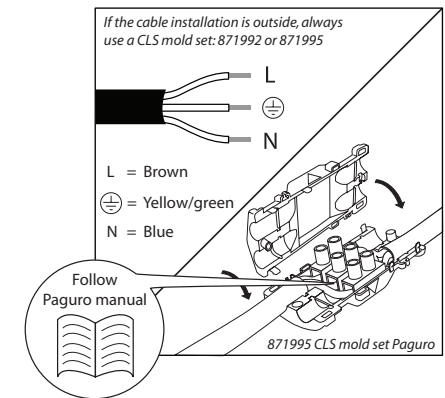
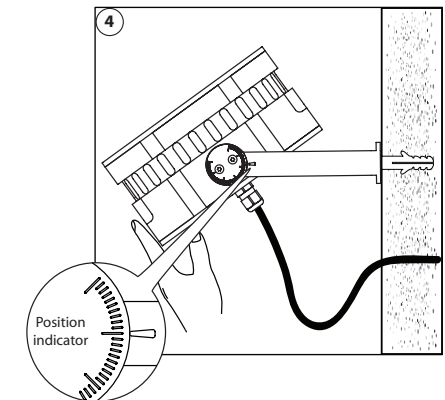
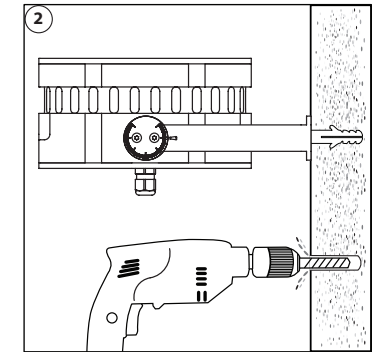
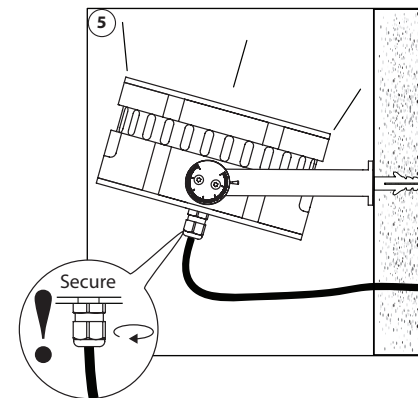
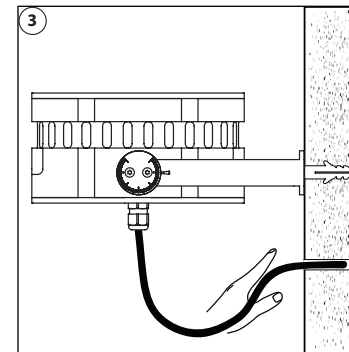
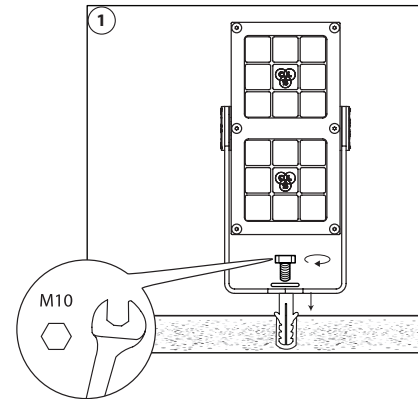

LENS REPLACEMENT

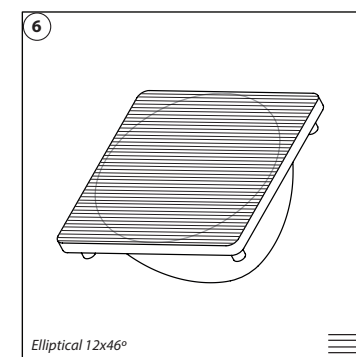
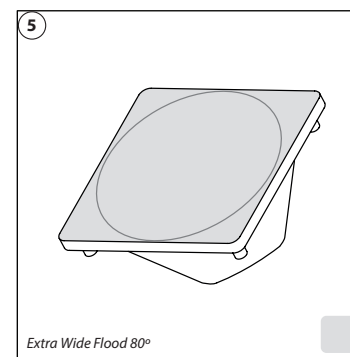
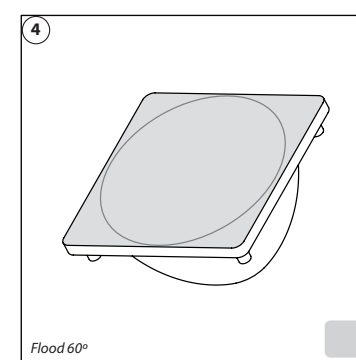
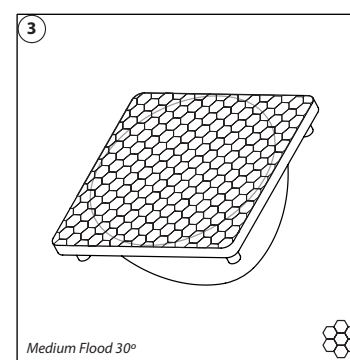
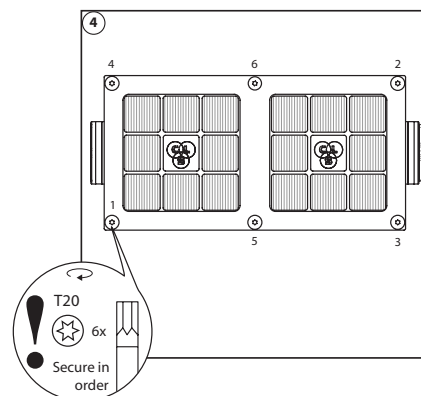
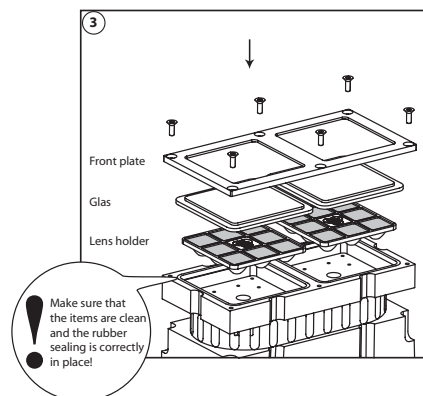
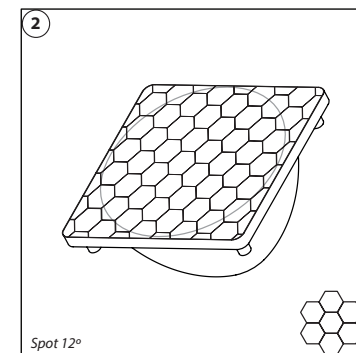
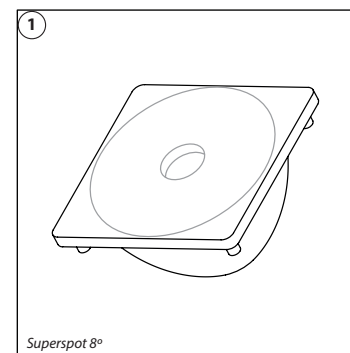
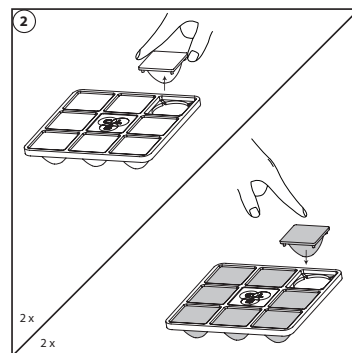
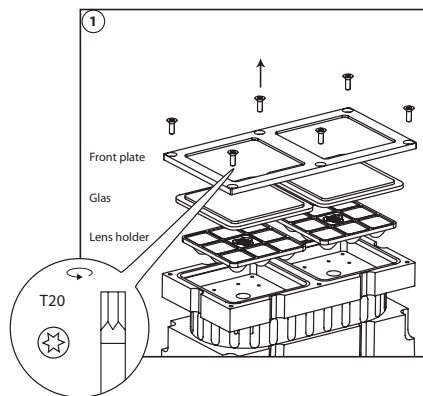

2025 CLS-LED BV. All rights reserved. Information subject to change without notice, CLS-LED BV and all affiliated companies disclaim liability for injury, damage direct or indirect loss, consequential or economic loss or any other loss occasioned by the use of, inability to use or reliance on the information contained in this manual. No part of this manual may be reproduced, in any form or by any means, without permission in writing from CLS-LED BV. Other legal information can be found in our General conditions, found on the back of your CLS-LED BV invoice, inside the CLS catalogue or on our website www.cls-led.com/General-Terms.pdf

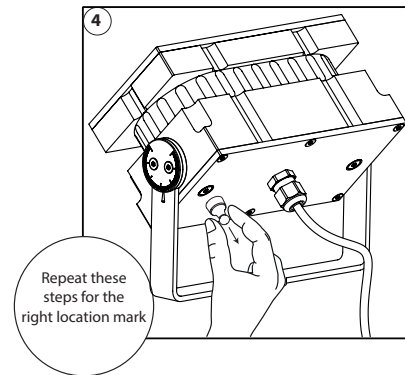
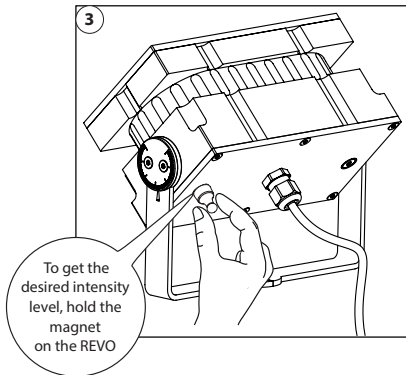
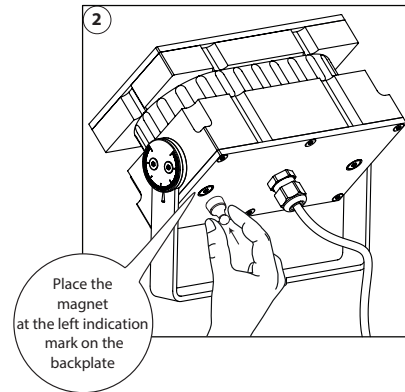
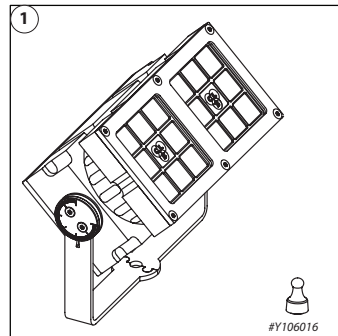

1. Place the magnet on the backplate, at the indicated spot.
2. The Revo XL starts slowly dimming from 100 – 1% in approx. 30 seconds. The dimming is very accurate and precise, so steps are very small.
3. At the desired intensity level, take away the magnet.
4. After 10 seconds the Revo XL flashes one time, the value has been stored on the internal memory.
5. When powering up the Revo XL, the stored value will be recalled from the internal memory.
6. If you want to have a lower value, replace the magnet and the Revo XL dims further to lower levels. To store the new setting repeat step 3 – 5.
7. If the Revo XL is being dimmed to Level 0 and you have not programmed a value, it will automatically start at Level 100 and dim back from 100 – 1%.

	Protection class One, two or three
	Application area Indoor or outdoor
	Application area Floor, wall or ceiling
	Swivel Fixture is horizontally rotatable, indicated in degrees
	Swivel Fixture is vertically rotatable, indicated in degrees
	Multiple connection Daisychain connectivity
	Installation depth In centimeters
	Installation size In centimeters
	Cable length Maximum cable attached to the fixture in centimeters
	Driver Inclusive or exclusive Internal or external
	Weight In grams/kilograms
	Pressure Maximum pressure on the fixture in kg/cm²
	Lifespan Of the light source in hours
	Lenses Available lenses, indicated in degrees
	Performance Zoom Adjustable beam angle
	LEDs Kind of LED used in the fixture
	Plug & play Easy connection using the SmartConnect system
	IP value Ingress Protection classifies the degrees of protection provided against the intrusion of the product
	Colour changing RGB, RGB-W, RGB-A, AWB or Tunable White

	Retail & Food LED modules Clothing, furniture, kitchens, jewellery, shoes, bread, meat, fish and vegetables & fruit.
	Colour Available colours: Amber, blue, red or green
	White colour temperature In different Kelvin values: Cold white, neutral white, warm white or extra warm white
	Curve Minimal bending curve in centimeters
	Cutting length Indicated by the cutting marks
	LED pitch Pitch between the LEDs in millimeters
	Power supply In VDC, VAC or milliAmpere
	Power consumption In VA or Watt
	Dimmable 1-10 Volt, Phase, individual, DMX dimmable or DALI
	PWM dimming Traditional PWM dimming, DMX analog or DMX Hybrid dim
	Bluetooth controlled By Casambi
	Magno dimming Accurate dimming from 100 - 1% by using a magnet
	Dynamic Control Dynamic Power Control or Dynamic Temperature Control
	DMX input Fixture works on DMX512 protocol or Wireless DMX
	Combined product Compose your own fixture
	Warranty 3 or 5 years warranty on the product
	Conformité Européenne CE marking for free marketability of industrial goods within the EU
	Energy label
	Lightsource Equipped with a CLS, Bridgelux or a Xicato LED module