

Index	2	Installation	4
Safety information	2	Lens replacement	5
Content	2	Lens index	6
Technical	3	Magno dimming	7
Specifications	3	List of symbols	8

SAFETY INFORMATION

Do not install in areas with open flames or heat sources.

Do not stare into the LED.

Ambiance  
Max. 40°

Qualified technician

Disconnect the power supply before installing or maintaining

Make sure all connectors are connected properly

Use a source of AC power that complies to local electrical codes

Block access below the work area when maintaining the unit

Don't modify or install genuine parts on this product

Don't install in a flammable or explosive area

Warning! Some surfaces can be hot

CONTENT

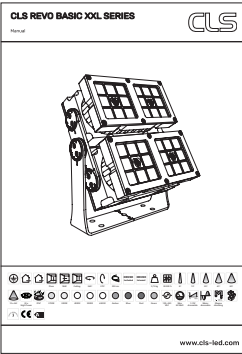
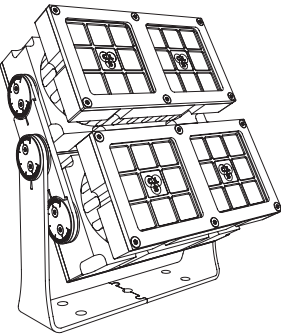

Floor

Wall

Ceiling

360°

270°

200 cm

5,75 kg

50.000 h

8°

12°

30°

61°

80°

12 x 46°

32 x High Power

IP67

2700K

3000K

4000K

5000K

6500K

Amber

Blue

Red

Green

100-240 VAC

Max. 80 Watt

1-10V dimmable

Mains dimmable

Magno dimming

3 YEAR WARRANTY

CE

A

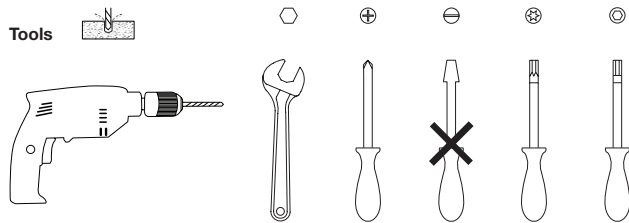
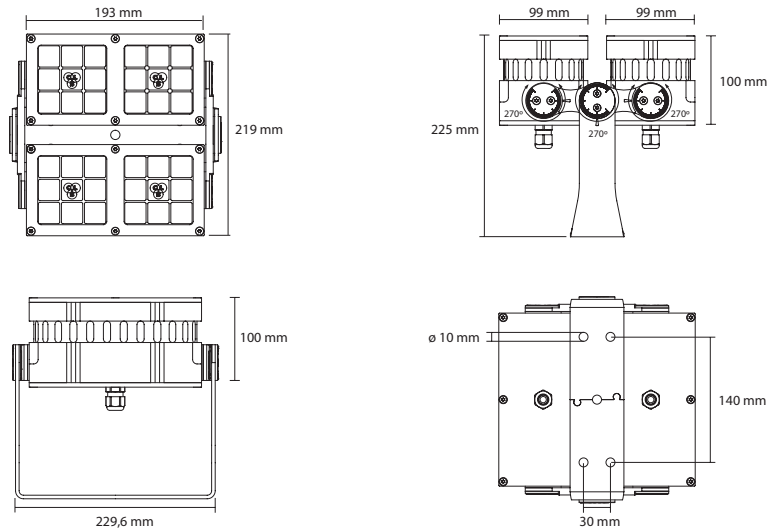

## SPECIFICATIONS

LED: 32 x High Power LED  
 Available colours: 2700K, 3000K, 4000K, 5000K, 6500K, amber, red, lime green, green and Royal blue  
 Lenses: 8°, 12°, 30°, 61°, 80 and 12x46°  
 Power supply: 100 ~ 240 VAC  
 Power factor: > 0,99 (115VAC), > 0,95 (230 VAC)  
 Power consumption: Max. 80 Watt  
 Housing: Anodised aluminum  
 Weight: 5,75 kg  
 IP value: IP67  
 Cable length: 2 meters  
 Ambient temperature: -30° C till +50° C

## ACCESSORIES

110415 CLS Revo lens kit superspot 8°, 8 lenses  
 110425 CLS Revo lens kit spot 12°, 8 lenses  
 110435 CLS Revo lens kit medium flood 30°, 8 lenses  
 110445 CLS Revo lens kit wide flood 61°, 8 lenses  
 110455 CLS Revo lens kit elliptical 12x46°, 8 lenses  
 871992 CLS mold set, straight 8-26mm  
 871995 CLS mold set Paguro grey  
 Y106016 CLS Magnet pin (4 pcs)  
 Y110795-G CLS Revo XL snoot grey  
 Y110795-B CLS Revo XL snoot black

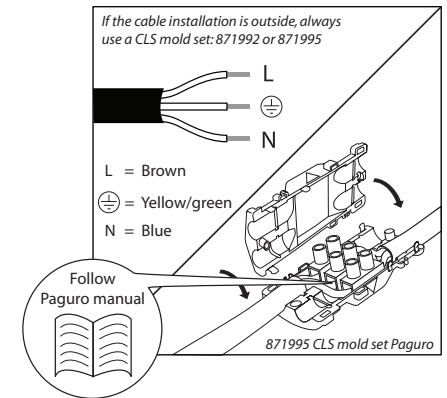
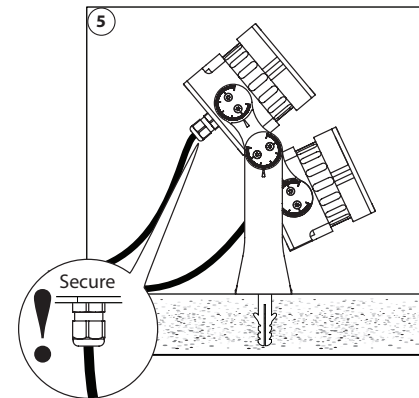
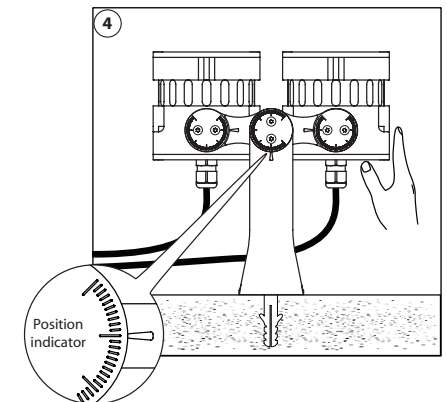
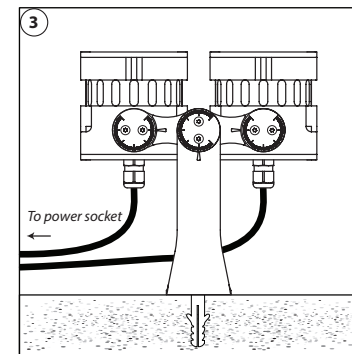
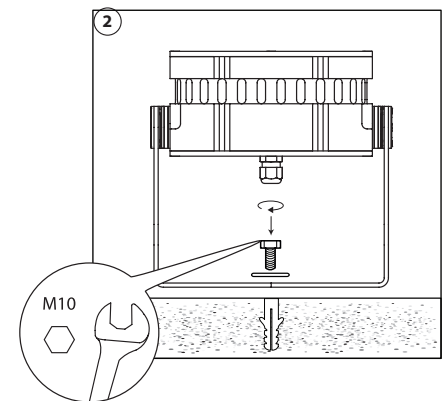
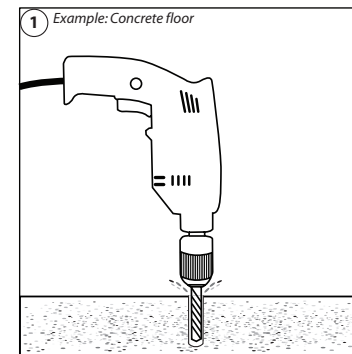

# LENS REPLACEMENT

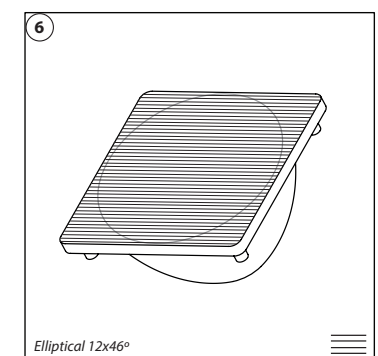
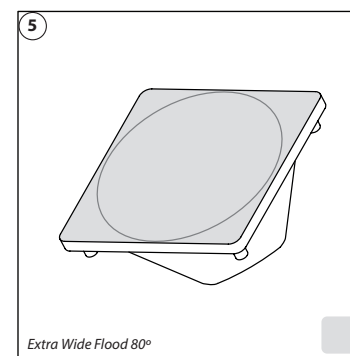
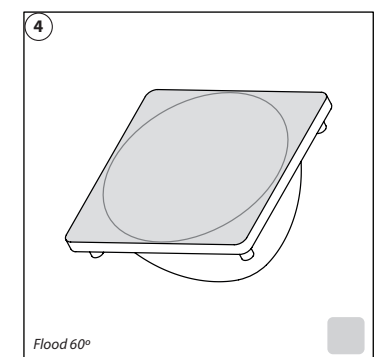
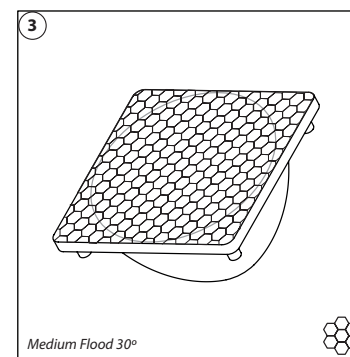
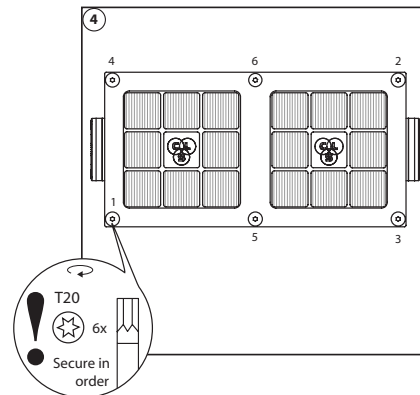
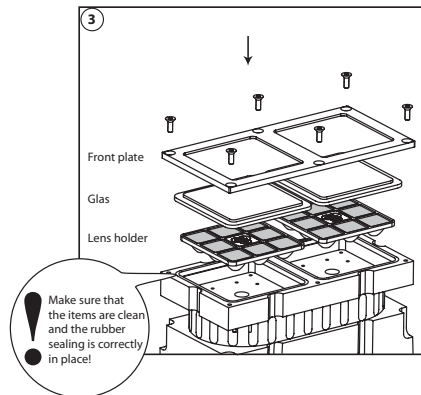
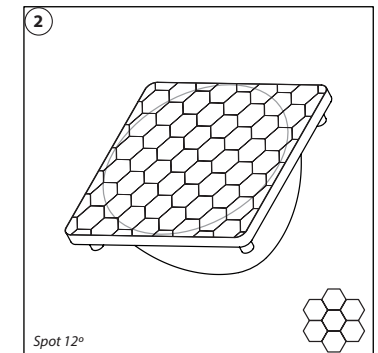
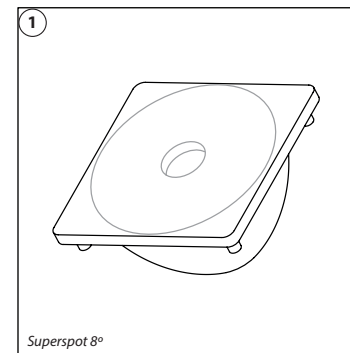
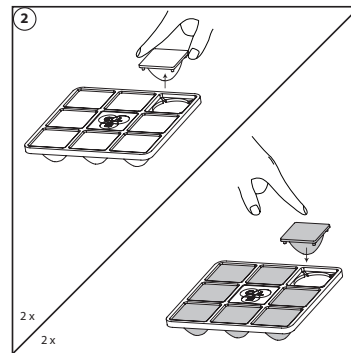
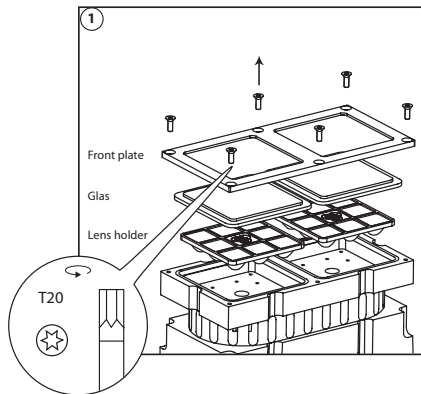

2025 CLS-LED BV. All rights reserved. Information subject to change without notice. CLS-LED BV and all affiliated companies disclaim liability for injury, damage direct or indirect loss, consequential or economic loss or any other loss occasioned by the use of, inability to use or reliance on the information contained in this manual. No part of this manual may be reproduced, in any form or by any means, without permission in writing from CLS-LED BV. Other legal information can be found in our General conditions, found on the back of your CLS-LED BV invoice, inside the CLS catalogue or on our website [www.cls-led.com/General-Terms.pdf](http://www.cls-led.com/General-Terms.pdf)

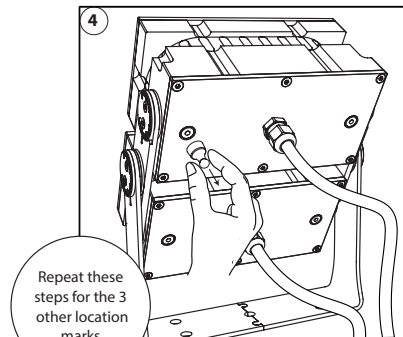
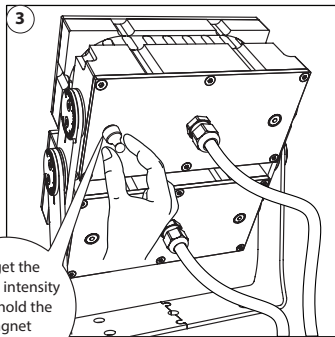
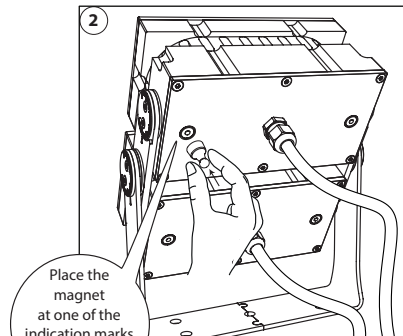
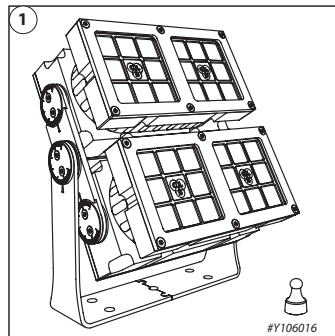

1. Place the magnet on the backplate, at the indicated spot.
2. The Revo XXL starts slowly dimming from 100 – 1% in approx. 30 seconds. The dimming is very accurate and precise, so steps are very small.
3. At the desired intensity level, take away the magnet.
4. After 10 seconds the Revo XXL flashes one time, the value has been stored on the internal memory.
5. When powering up the Revo XXL, the stored value will be recalled from the internal memory.
6. If you want to have a lower value, replace the magnet and the Revo XXL dims further to lower levels. To store the new setting repeat step 3 – 5.
7. If the Revo XXL is being dimmed to Level 0 and you have not programmed a value, it will automatically start at Level 100 and dim back from 100 – 1%.

	<b>Protection class</b> One, two or three		<b>Retail &amp; Food LED modules</b> Clothing, furniture, kitchens, jewellery, shoes, bread, meat, fish and vegetables & fruit.
	<b>Application area</b> Indoor or outdoor		<b>Colour</b> Available colours: Amber, blue, red or green
	<b>Application area</b> Floor, wall or ceiling		<b>White colour temperature</b> In different Kelvin values: Cold white, neutral white, warm white or extra warm white
	<b>Swivel</b> Fixture is horizontally rotatable, indicated in degrees		<b>Curve</b> Minimal bending curve in centimeters
	<b>Swivel</b> Fixture is vertically rotatable, indicated in degrees		<b>Cutting length</b> Indicated by the cutting marks
	<b>Multiple connection</b> Daisychain connectivity		<b>LED pitch</b> Pitch between the LEDs in millimeters
	<b>Installation depth</b> In centimeters		<b>Power supply</b> In VDC, VAC or milliAmpere
	<b>Installation size</b> In centimeters		<b>Power consumption</b> In VA or Watt
	<b>Cable length</b> Maximum cable attached to the fixture in centimeters		<b>Dimmable</b> 1-10 Volt, Phase, individual, DMX dimmable or DALI
	<b>Driver</b> Inclusive or exclusive internal or external		<b>PWM dimming</b> Traditional PWM dimming, DMX analog or DMX Hybrid dim
	<b>Weight</b> In grams/kilograms		<b>Bluetooth controlled</b> By Casambi
	<b>Pressure</b> Maximum pressure on the fixture in kg/cm²		<b>Magne dimming</b> Accurate dimming from 100 - 1% by using a magnet
	<b>Lifespan</b> Of the light source in hours		<b>Dynamic Control</b> Dynamic Power Control or Dynamic Temperature Control
	<b>Lenses</b> Available lenses, indicated in degrees		<b>DMX input</b> Fixture works on DMX512 protocol or Wireless DMX
	<b>Performance Zoom</b> Adjustable beam angle		<b>Combined product</b> Compose your own fixture
	<b>LEDs</b> Kind of LED used in the fixture		<b>Warranty</b> 3 or 5 years warranty on the product
	<b>Plug &amp; play</b> Easy connection using the SmartConnect system		<b>Conformité Européenne</b> CE marking for free marketability of industrial goods within the EU
	<b>IP value</b> Ingress Protection classifies the degrees of protection provided against the intrusion of the product		<b>Energy label</b>
	<b>Colour changing</b> RGB, RGB-W, RGB-A, AWB or Tunable White		<b>Lightsource</b> Equipped with a CLS, Bridgelux or a Xicato LED module