

Ruby Series

Track - Pendant - Bracket & Surface Mounted Fixtures



Powerful white & coloured light combined in stylish fixtures

> Ruby Series Track – Pendant – Bracket & Surface Mounted Fixtures

CLS is launching a complete new fixture family with unique application possibilities. The Ruby series is the result of many worldwide brain storm sessions with lighting designers & architects. What they desired, but could not find until now, was a lighting solution with powerful white light and coloured light in one single fixture. We started with the design of a RGBW variant and have expanded the portfolio to a family of fixtures with unparalleled choices in lighting colours & control variants.

Good quality white light is essential for any working, living or leisure environment. Besides that one wishes often being able to create colours in spaces in order to create a certain ambience in spaces.

Ruby series; A unique approach in multifunctional lighting

Imagine that you are able to:

- > To adjust the colour temperature of light from candlelight to clear day light so that your light system can synchronise with the rhythm of the days and seasons.
- > To lighting up objects or spaces in millions of subtle colours to attract attention.
- > Change the ambient of a exhibition hall into a warm cosy environment for dinner and sales events.
- > Turn your showroom into a festivity room during special occasions and product presentations.
- > Use the same lighting system for both functional lighting and special occasion events in large spaces and no need to rent extra lighting with all costs involved.

Basically one can use the Ruby series in any environment where a good quality white light is needed and where one also wishes to be able to generate colours in order to create a certain ambience.

Housing variations

The Ruby Colour Flow series offers no less than 4 different mounting variants.

One can choose from a; Pendant- Surface- Bracket or Railmount pendant version.



Some typical applications for the Ruby Colour Flow series:

- > Theatres & concert halls
- > Event centres
- > Exhibition centres
- > Museums & Science centres
- > Atriums & Auditoria
- > Large showrooms
- > Conference centres
- > Shopping centres
- > Kids play ground centres

Besides the locations mentioned above, you can probably imagine far many more places to use the new CLS Ruby series.

Unparalleled choice in lighting sources

The Ruby series are available with the following lighting sources:

- > White light in 2700K, 3000K, 3500K, 4000K & 5000K.
Several CRI options are available from ≈80 up to ≈95 depending on your specific needs.
- > Tunable White in 1800K-4000K & 2700K-5000K.
- > RGBW & RGBA.
- > Dim2Warm in 1800K-3000K.



Homogeneous & shadow free colour mixing

By using advanced software for the calculation of the optical design our engineers came with a unique solution. The use of a specially designed mixing chamber for the colours in combination with a extreme narrow placing of the 4 different LED colours has led to unknown good colour mixing for the RGBW and RGBA fixtures without any shadows.



> Ruby Series Track - Pendant - Bracket & Surface Mounted Fixtures

Available in several system powers

The Ruby series are available in 22W, 30W, 45W, 60W and 110W power versions. Please note that not all lighting sources are available in all power versions. Please check the fixture configurator on our website.

Large choice in dimming & control options

The CLS Ruby series offers a wide choice of dim methods. Even more important is the fact that the quality of the dimming is unprecedentedly high. It has its reasons why users choose the LED solutions from CLS in applications where the quality of the dimming is of the utmost importance. In this way, besides museums & galleries, also theatre's & concert halls and many hotels around the world are equipped with CLS fixtures.

CLS offers a choice between the following dimming methods:

- > 1-10V
- > DALI
- > Mains (Phase-cut)
- > DMX 512
- > Wireless DMX
- > Wireless Bluetooth control by Casambi

(Please note, not all control options are available for all versions, in case of doubt please contact your local CLS distributor)



DMX
512



DMX dimming to very low levels without any flickering

The advanced electronic circuits of the DMX versions 2 sophisticated dimming methods;

- > Hybrid dimming
- > Full Analog dimming

DMX
HYBRID
DIM

DMX
ANALOG
DIM

Users can select their favourite dimming method on the fixture. In 99,9 % of all situations these options make sure that you will not encounter any flickering issue's in demanding environments like TV studios. It also means that the Ruby fixtures are allowed in buildings that want to apply for a Breeam certification. (pwm dimming is not allowed in Breeam certified buildings)

For ultra smooth dimming in the lowest area's the dmx versions are equipped with the Dynamic Soft Dim functionality. This extra DMX channel offers dynamic control of the dimming curve.

DYNAMIC
SOFT
DIM

Choice of several beam angles

The Ruby comes available with a choice in a spot, medium flood and wide flood beam angle.

Larger beam angles are available by the use of optional beam shapers.



16°



49°



63°

Accessories

For situations where a reduction in the glare is desired, CLS offers a honeycomb as a accessory. Colour correction and beam filters can easily be installed in the front ring of the Ruby.



Seamless integration with its environment

The Ruby series are standard available in a black or white matt finish, which will ensure seamless integration in most interiors. CLS offers the possibility to have the Ruby delivered in almost any RAL colour. In this case extra costs and MOQ will apply.

A Sound Investment

Components of the highest possible quality are used for the production of the Ruby without compromise. Unlike many other suppliers on the market who only claim to do so, CLS actually **designs and produces its fixtures in The Netherlands**. CLS belongs to a group of companies with more than 25 years of expertise in the professional lighting business.

> **Ruby Series** Track - Pendant - Bracket & Surface Mounted Fixtures



De Oosterpoort, The Netherlands



Warmuseum Overloon, The Netherlands

> **Ruby Series** Track - Pendant - Bracket & Surface Mounted Fixtures



Noorderchurch, The Netherlands



ESMO Fair Madrid Spain

> **Ruby Series** Track - Pendant - Bracket & Surface Mounted Fixtures

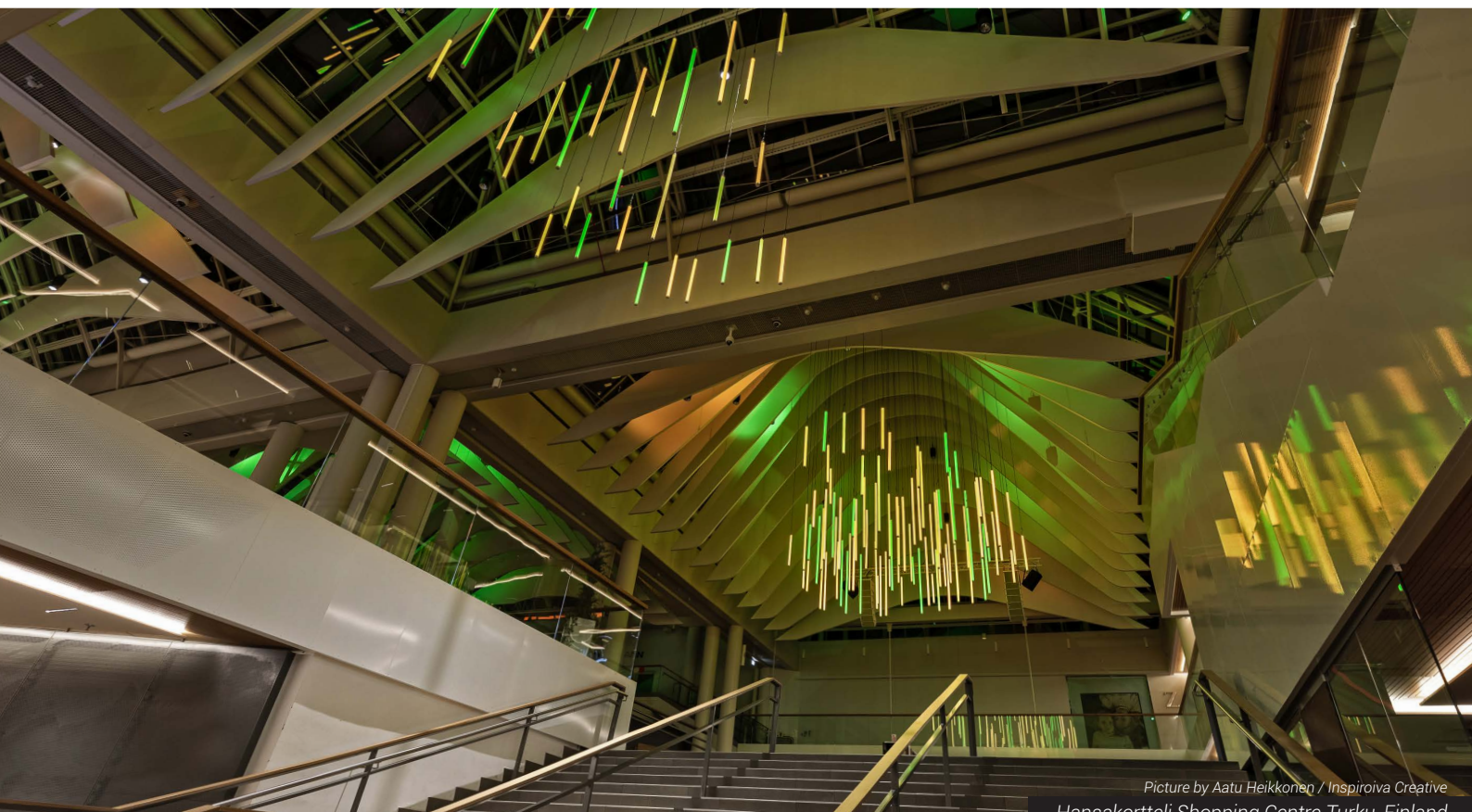

Picture by Aatu Heikkonen / Inspirova Creative
Hansakortteli Shopping Centre Turku, Finland



Westergasfabriek Amsterdam, Netherlands

> **Ruby Series** Track - Pendant - Bracket & Surface Mounted Fixtures



In Holland, Amsterdam



Sint Urbanus Te Bovenkerk, Netherlands

> Ruby Series Track - Pendant - Bracket & Surface Mounted Fixtures

Measurements Ruby

Ruby Pendant

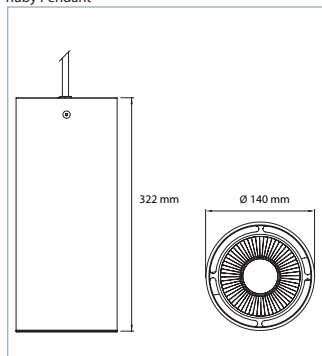

Ruby Pendant Track

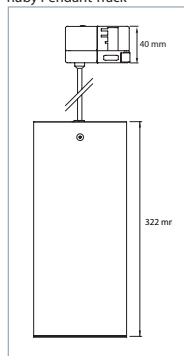

Ruby Surface

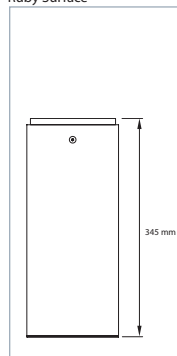

Ruby Bracket

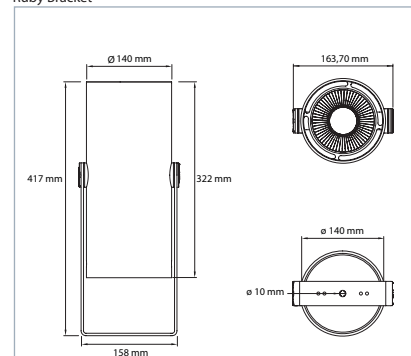

Technical specifications

LED:	Citizen, CLS Dynamic Colour Chip
Available colours:	CRI 80: 2500K, 2700K, 3000K & 4000K CRI 92: 2700K, 3000K, 3500K, 4000K & 5000K RGBW/RGBA Tunable White Dim To Warm 1800K - 3000K
Beam angles:	16°, 49°, 63°
Power supply:	200 ~ 240 VAC
Power factor:	> 0.91
Ambient temperature:	-10 °C till 40 °C

Power consumption:	5 serie: Max. 22 Watt 6 serie: Max. 30 Watt 7 serie: Max. 45 Watt 8 serie: Max. 60 Watt 9 serie: Max 110 Watt (Colour Flow Series)
Housing:	Black or white coated anodised aluminium
IP value:	IP20
Cable length:	Pendant: 200, 400, 600 or 800 cm Track: 200, 400, 600 or 800 cm Bracket: 200 cm
Ambient temperature:	-10 °C till 40 °C

Icons

Colour & colour temperatures

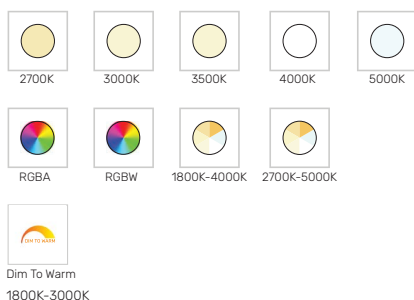

General specifications

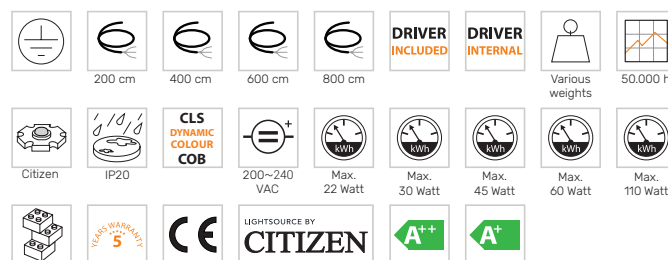

Optics

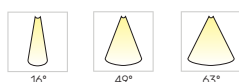

Mounting options

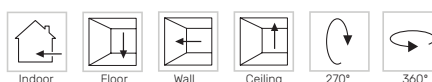

Housing & finish

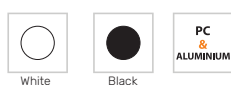

Control options

